

festoon lighting



LED - 2023

INSTRUCTION BOOKLET

for use with: connect60 system / 6-60mm Panels

info@connectexhibitions.co.uk

tel: Ed - 07958 468 427/ 01227 719 743

Connect Exhibitions Ltd

Unit 13, Canterbury Industrial Park

Island Road, Hersden

Canterbury, Kent

CT13 4HQ



C8 to C15 Adapter.

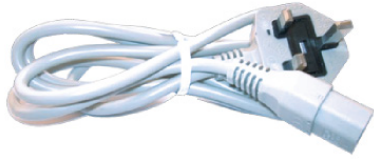

Power Lead (1m -10m)

Supply Voltage: 220 - 240V

1.8m daisy chain linking lead

connect

female C8

male C7

530mm

50mm

Type/Size: GU10 - LED/Diffuse/120°/ 8W max.



QR / download



C7 to C8 Jumper Lead (2m)

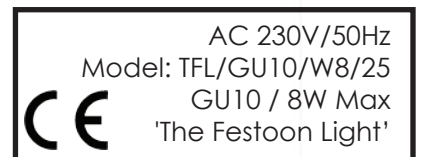
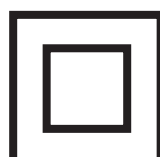
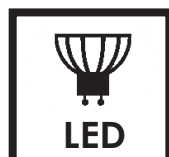

Class II

Lighting Safety and Installation Instructions:

Instructions for attaching to the Connect Wall System.

1. The Festoon Lights are linked together by simply joining the output lead from one light to the input lead of another. A Maximum of 25 lights can be join in one continuous chain. The linking leads allow upto 1500mm of space between lights (2x connect60 panels).

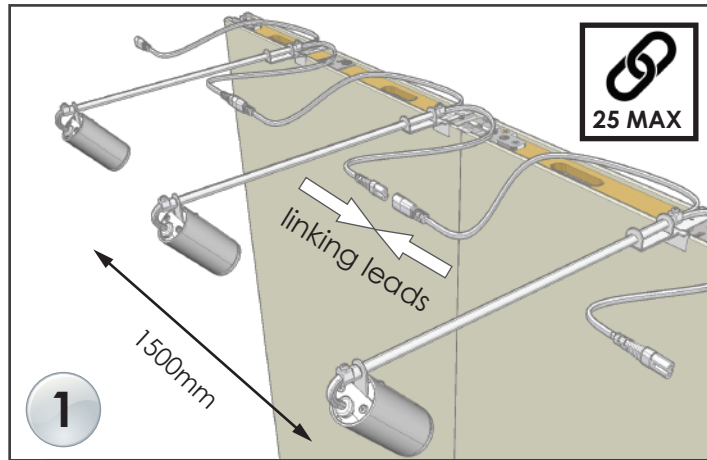

2. When Fitted with the 'Connect Wall Bracket' (60mm/6mm) 'The Festoon Light' can then be placed and push-fitted onto the top of your Connect Panels. A slight adjustment by bending/closing of the bracket gap will ensure a tight fit.

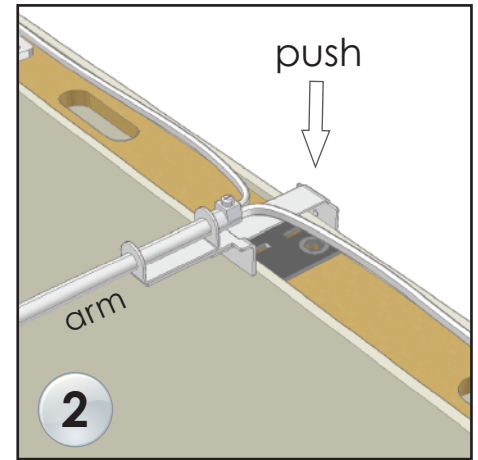

Additional Leads and Connectors used:

Supplied by Connect Exhibitions Ltd:

1. IEC - C14 to C15 Extention Lead (10m).
2. C8 to C15 Adapter.
3. Fused A3 UK 3 pin plug to IEC - C15 Power Lead (0.5m).
4. Fused A3 UK 3 pin plug to IEC - C7 Power Lead (10m).
5. 2 pin EU to IEC - C7 Power Lead (10m).
6. IEC - C7 to C8 Jumper Lead (between linked light units)(2m).

Suggested - supplied by 3rd party companies:

1. RCD unit (safety/surge automatic cut-off for each 3A 3-pin (UK) plug power supply used).

3. The power lead (purchased separately) connects to the C8 input lead of the first Festoon Light to an electrical supply. The use of various extentions / adapters / power cables that have a IEC/C7 output from the a 3A 3-pin (UK) plug, supplies the power.

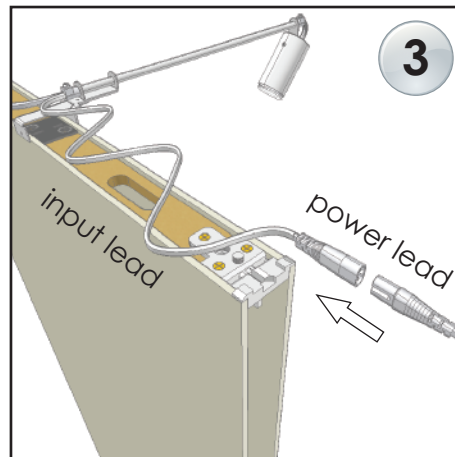

4. Double sided wall lighting should first go along one side of wall and then return on the other side. After linking all the lighting units all the cables should be tidied up using standard plastic cable clips and ties.

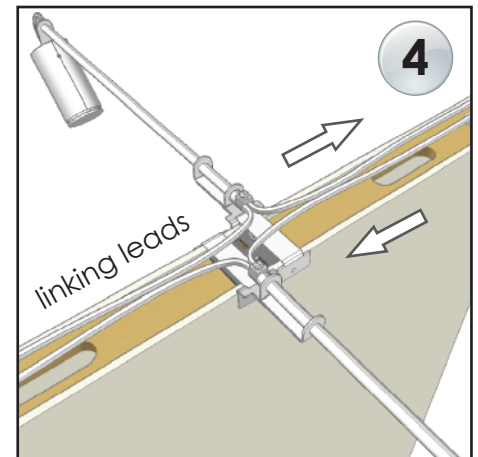

GB Lighting Safety / Installation:

- 'The Festoon Light' - This product is for indoor use ONLY.
- The product is ONLY suitable for installation on surfaces with normal flammability e.g. wood, plasterboard, masonry. It is not suitable for use on highly flammable surfaces (e.g. polystyrene, textiles).
- Before making any 'Wall Mount' fixing holes, check that there are no obstructions hidden beneath the mounting surface such as pipes or cables.
- The product is designed ONLY for connection to a 240V wall socket via an extention lead with a 3A fused three pin UK plug to a IEC (EN20 320-1 / C14) plug. We recommend that the wall socket incorporates a switch for ease of operation and an additional RCD unit.
- Do not attach the product to surfaces which are damp or otherwise electrically conductive (e.g. metallic surfaces).
- Cleaning: Unplug the product and clean with a soft damp cloth, then leave to dry fully. Do not use strong chemical or abrasive cleaners.
- Bulb Replacement: Disconnect the product from the electricity supply before replacing lamps - ONLY use LED GU10 / 8W MAX lamps.

WARNING: With this product -

- ONLY use additional leads or connectors that have been specifically stated for use in the instructions supplied.
- ALWAYS check that this product and any additional leads or connectors to be used are in good condition before connecting them to an electrical supply.
- DO NOT open the metal body of the product.
- IMPORTANT: Failing to follow these warnings will invalidate your guarantee and could present a severe electrical shock hazard.

When your light fitting comes to the end of it's life or you choose to update or upgrade it by replacing it, please do not dispose it with your normal household waste, please recycle where facilities exist. Check with your local authority for suitable options. New regulations will encourage the recycling of Waste from Electrical and Electronic Equipment (European "WEEE Directive" effective August 2005).

